

FaceStation F2

Fusion Multimodal Terminal



Unrivaled
Face Recognition
Performance



Best-in-class
Multimodal Device



Contactless Solution
for the New Normal



Robust Device Security and
Data Encryption



Unrivaled face recognition performance by Fusion Matching

FaceStation F2 boasts exceptional authentication accuracy achieved by the fusion matching of visual and infrared(IR) face recognition.

*False Acceptance Rate(FAR) of 1 in 10 billion.



- Suprema's unique algorithm optimizes IR and visual face recognition to produce the industry's best face recognition and anti-spoofing performance
- Proven track record of authentication performance regardless of user ethnicity and face changes powered by deep learning algorithm

Best-in-class multimodal with various credentials

FaceStation F2 offers a wide range of authentication options including face, mobile access, fingerprint and cards.



Face



Mobile Access



Fingerprint



Card

- Register up to 100,000 users for fingerprints authentication and 50,000 users for face authentication
- Supports dual frequency access cards, NFC and BLE-based Mobile Access Cards
- Access-on-card allows authentication via biometric data stored in cards



Contactless solution for new standards of safety and hygiene

FaceStation F2 meets the needs of the post-pandemic world with remote and contactless solution.

- Detects and limits access of users not wearing masks
- Face recognition of users wearing masks
- Remote user enrollment through profile photo uploads
- Combines with Suprema Thermal Camera to identify users with elevated skin temperature

Robust device security and data encryption

FaceStation F2 is equipped with security measures to protect user data.

- Highest level of device security including secure booting process
- Encrypts all biometric credentials and personal information
- Built on Android and all its security enhancements



System Configurations

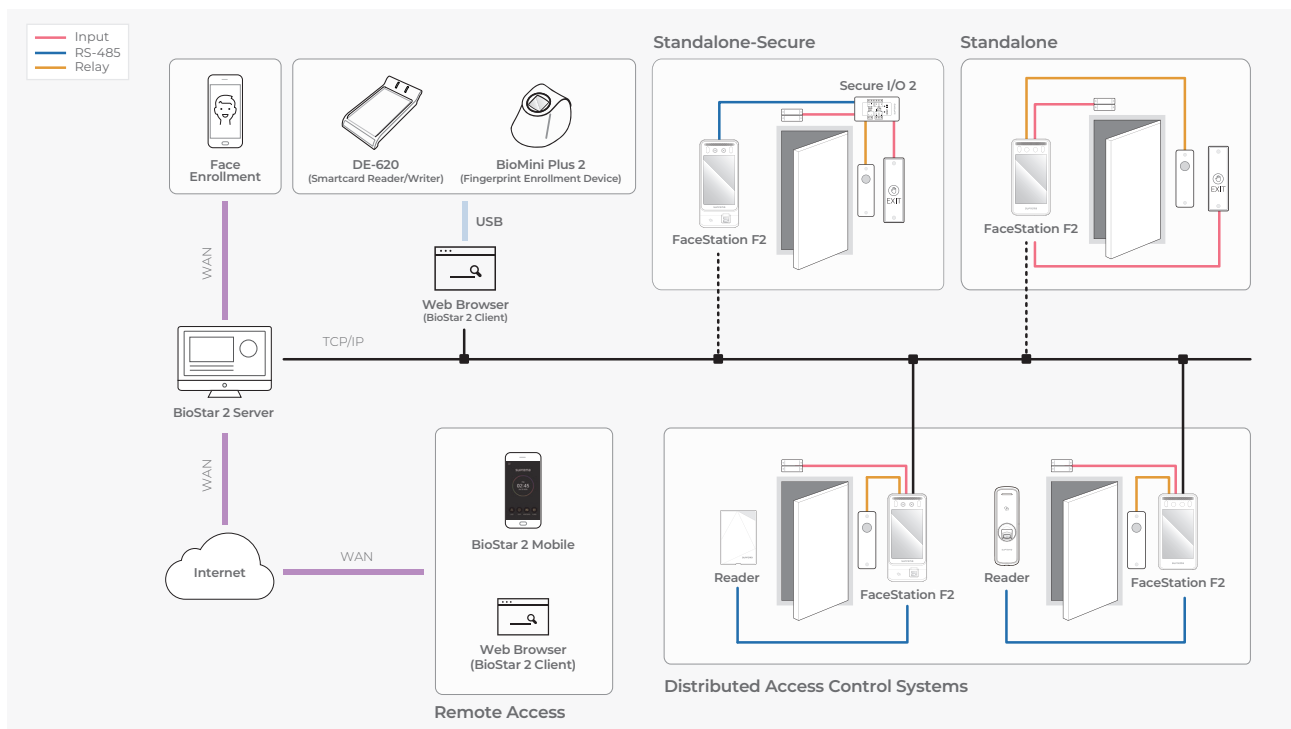

Product Specification



Category	Feature	FSF2-DB	FSF2-AB	FSF2-ODB	
Credential	Biometric	Face		Face, Fingerprint	
	RF Option	125kHz EM & 13.56MHz MIFARE, MIFARE Plus, DESFire EV1/EV2, FeliCa	125kHz EM & 13.56MHz MIFARE, MIFARE Plus, DESFire EV1/EV2, FeliCa, iCLASS SE/SR/Seos	125kHz EM & 13.56MHz MIFARE, MIFARE Plus, DESFire EV1/EV2, FeliCa	
	RF Read Range*	EM/MIFARE/DESFire : 50 mm (2"), FeliCa: 30 mm (1.2") * RF read range will vary depending on the installation environment			
General	Mobile	NFC, BLE			
	CPU	1.8 GHz Dual Core + 1.4 GHz Quad Core			
	Memory	16GB Flash + 2GB RAM			
	LCD Type	7" IPS color LCD			
	LCD Resolution	800 x 1280 pixels			
	Sound	16bit			
	Operating Temperature	-20°C ~ 50°C (-68°F ~ 122°F)			
	Operating Humidity	0% ~ 80%, non-condensing			
	Dimension (W x H x D)	119.8mm x 223mm x 23.5mm (4.7" x 8.8" x 0.9")		119.8mm x 268.4mm x 49.7mm (4.7" x 10.6" x 1.9")	
	Weight	Device	585g		670g
		Bracket (Including washer and bolt)	181g		205g
IP Rating	IP65				
Certificates	CE, FCC, KC, RoHS, REACH, WEEE				
Face	Recognition Distance	0.5m ~ 1.3m (19.7" ~ 51.2")			
	Recognition Height	140cm ~ 190cm (55.1" ~ 74.8")			
	Matching Speed	Less than 0.5 sec			
	Live Face Detection (Anti-Spoofing)	Supported			
Fingerprint	Image Dimension			300 x 400 pixels	
	Resolution			500 dpi	
	Template	N/A		SUPREMA / ISO19794-2, ANSI-378	
	Extractor / Matcher			MINEX certified and compliant	
	Sensor Certificates			FBI PIV and FBI Mobile ID FAP20	
	Live Fingerprint Detection			Supported (SW-based)	
Capacity	Max. User (1:1) * Based on one face/fingerprint enrollment per user	100,000			
	Max. User (1:N) * Based on one face/fingerprint enrollment per user	Face: 50,000		Face: 50,000 Fingerprint: 100,000	
	Max. Text Log	5,000,000			
	Max. Image Log	50,000			
Interface	Ethernet	10/100 Mbps, auto MDI/MDIX			
	RS-485	1ch Host or Slave (Selectable)			
	Wiegand	1ch Input, 1ch Output			
	TTL Input	2ch Inputs			
	Relay	1 Relay			
	USB	USB 2.0 (Host)			
	Tamper	Supported			
Power	Voltage: DC 12V ~ DC 24V Current: Max. 2.5 A * Use a 24V/2.5A adapter. Must follow the product manual when using a 12V adapter.				



Suprema Inc.

17F Parkview Tower, 248, Jeongjail-ro, Bundang-gu, Seongnam-si, Gyeonggi-do, 13554, Republic of Korea

T +82 31 783 4502 E sales_sys@supremainc.com www.supremainc.com



For more information about Suprema's global branch offices, visit the webpage below by scanning the QR code.

<https://www.supremainc.com/en/about/contact-us.asp>